

## B STAGE TECHNICAL SHEET

DIMENSIONS	GROSS m	GROSS ft	NET m	NET ft
Length	48.4 m	158.79 ft	45.8 m	150.26 ft
Width	29.2 m	95.8 ft	26.6 m	87.27 ft
Stage size	1 413.2 m <sup>2</sup>	15 211 sq ft	1 218.3 m <sup>2</sup>	13 221.3 sq ft
HEIGHT	METERS	FEET		
Building Height	14 m	45 ft		
Working Height	9.6 m	31.6 ft		
FLOOR TYPE	Concrete			
CATWALK	YES			
ELECTRICAL SUPPLY	Maximum electrical load 172 Kw 1xCamLock, 6x3x125 A, 6x3x63 A, 6x3x32 A			
PAYLOAD	Payload 5 tons/m <sup>2</sup>			
HEATIG/COOLING	Air handling units YES			
FIRE PROTECTION	Smoke Detectors YES			
WATER	Water on stage YES			
DATA	Internet / Network Connectivity YES			

## B STAGE ROOMS INCLUDED IN THE RENTAL

ID No.	Room Name	Area (m <sup>2</sup> )	Area (sq ft)
005	MAKE-UP ROOM (w 1 toilet & 1 shower)	19.0	204.5
006	MAKE-UP ROOM (w 1 toilet & 1 shower)	17.5	188.4
007	MAKE-UP ROOM (w 1 toilet & 1 shower)	17.3	186.2
008	MAKE-UP ROOM	25.3	272.3
009	DIMMER ROOM	15.2	163.6

## B STAGE GROUNDPLAN

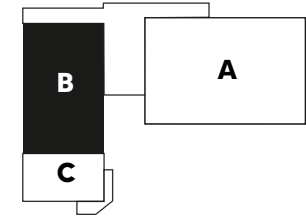
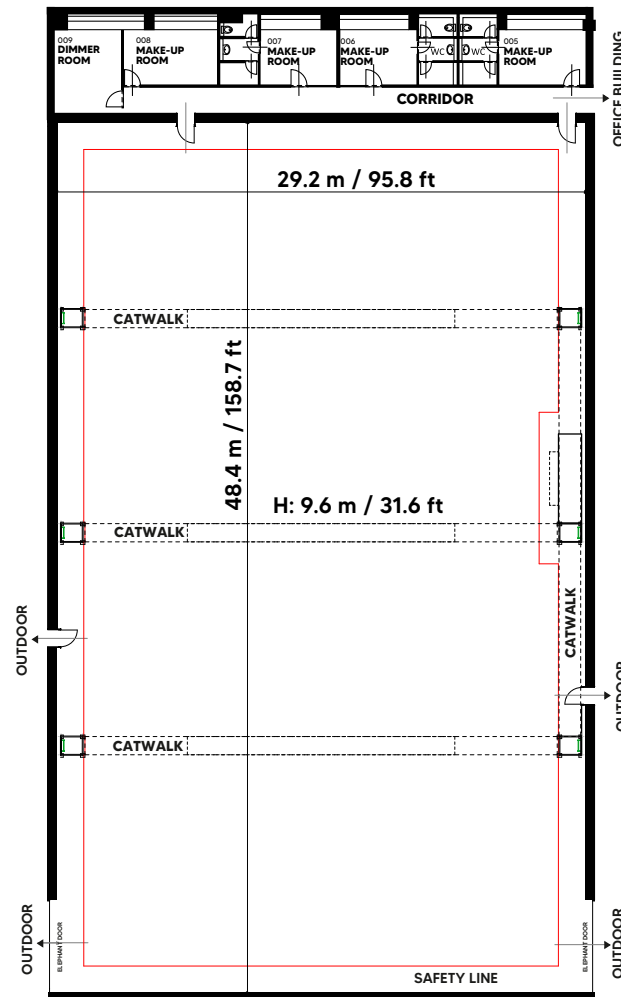

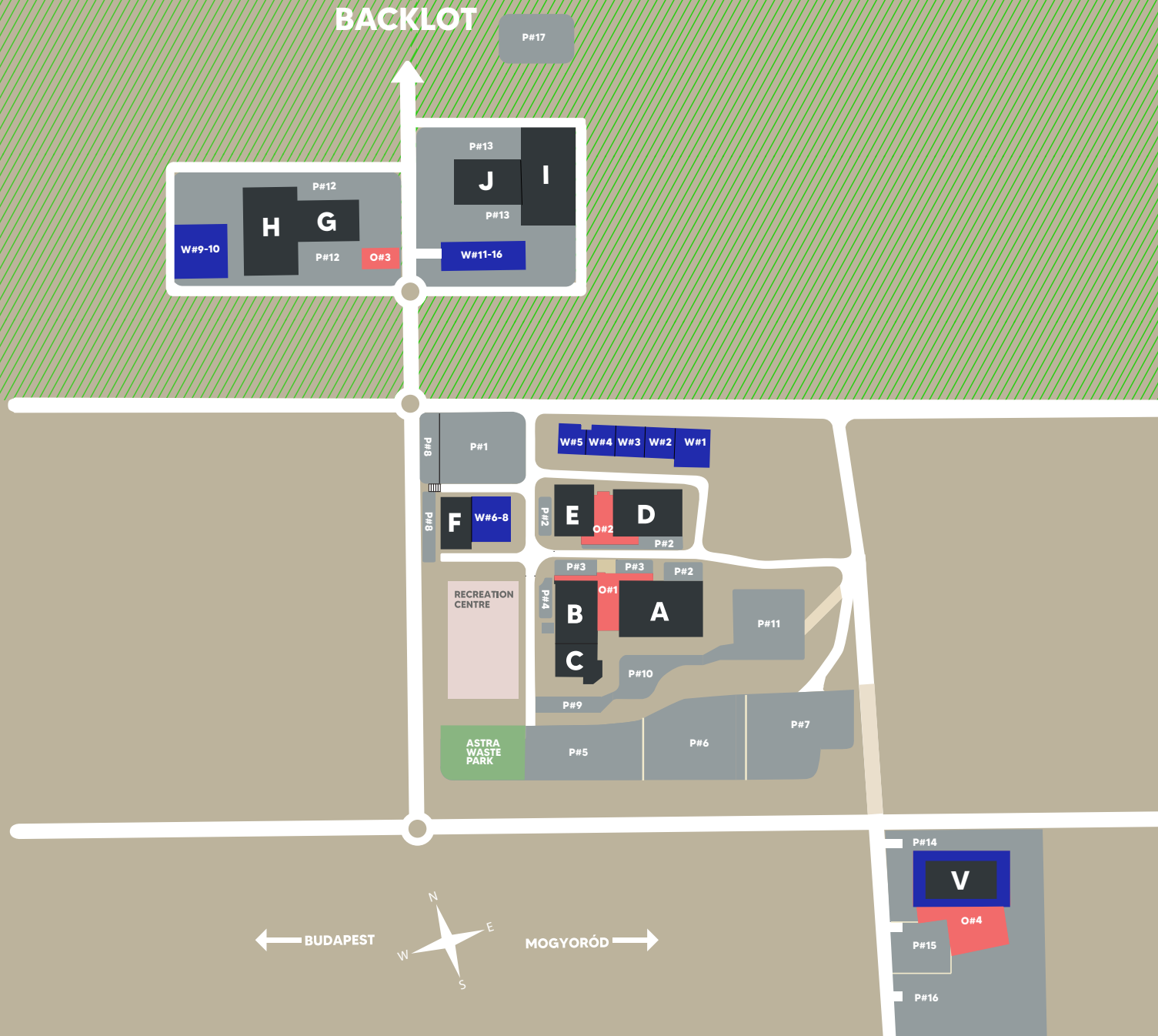

 **ASTRA  
FILMLAND**

**B STAGE**

