

C STAGE TECHNICAL SHEET

| DIMENSIONS | GROSS m | GROSS ft | NET m | NET ft |
|-------------------|---|-------------|--------------------|---------------|
| Length | 29.5 m | 96.7 ft | 26.8 m | 87.9 ft |
| Width | 17.1 m | 56.3 ft | 14.6 m | 47.9 ft |
| Stage size | 504.4 m ² | 5 429 sq ft | 391 m ² | 4 208.6 sq ft |
| HEIGHT | METERS | FEET | | |
| Building Height | 14 m | 45 ft | | |
| Working Height | 11 m | 36.08 ft | | |
| FLOOR TYPE | Concrete | | | |
| CATWALK | NO | | | |
| ELECTRICAL SUPPLY | Maximum electrical load 86 Kw 2x3x125 A, 2x3x63 A, 2x3x32 A | | | |
| PAYLOAD | Payload 5 tons/m ² | | | |
| HEATIG/COOLING | Air handling units YES | | | |
| FIRE PROTECTION | Smoke Detectors YES | | | |
| WATER | Water on stage YES | | | |
| DATA | Internet / Network Connectivity YES | | | |

C STAGE GROUNDPLAN

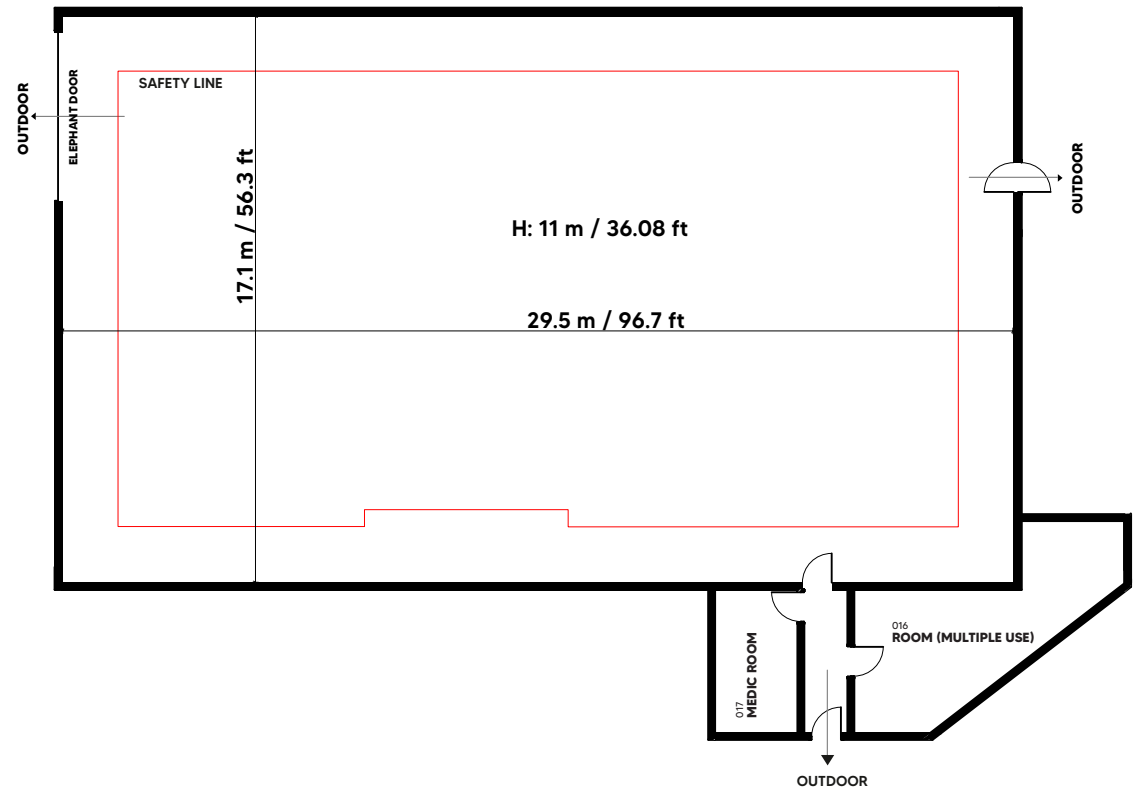
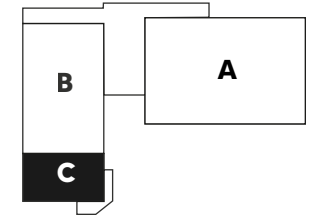

C STAGE ROOMS INCLUDED IN THE RENTAL

| | | | | |
|--------|-----|---------------------|----------------------|-------------|
| ID No. | 015 | MEDIC ROOM | 14.76 m ² | 158.8 sq ft |
| ID No. | 016 | ROOM (multiple use) | 31.55 m ² | 339.5 sq ft |